

**SCHEMATIC ROOF TRUSS DETAIL**

**ROOF NOTES:**  
 ROOF COVER: 1.5 mm  
 IBR ON 75 x 50 PURLINS  
 @ 1000 C/C

ROOF PITCH 24°  
 GANG-NAILED  
 TRUSSES 114 x 38

6 mm GYPSUM CEILING  
 BOARD ON 38 x 38  
 BRANDING @ 600 mm  
 C/C

FASCIA 208 x 32  
 WALL PLATE 125 x 38

**INCOMPLETE FOUNDATION AND WALL DETAIL**

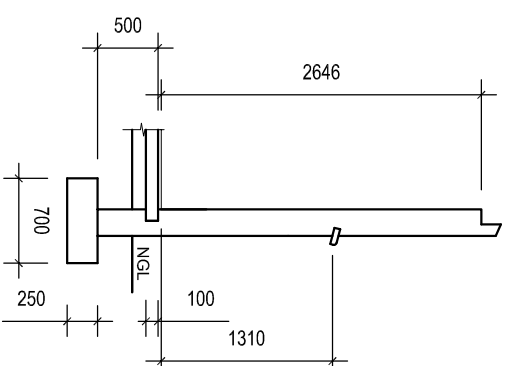

**DOOR AND WINDOW SCHEDULE**

**DOOR**  
 3 HW FRAMED, LEDGED AND BATTENED  
 IRONMONGERY  
 3 PAIRS OF 75 mm BRASS HINGES and SCREWS  
 3 TWO-LEVER LOCKSETS

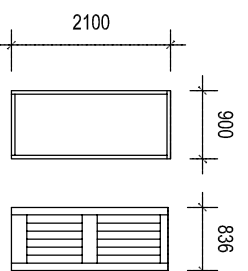

**DOOR FRAME**  
 2 INTERNAL, 1 EXTERNAL  
 STANDARD HARDWOOD

**DOOR FRAME PROFILE**  
 STANDARD, MERANTI

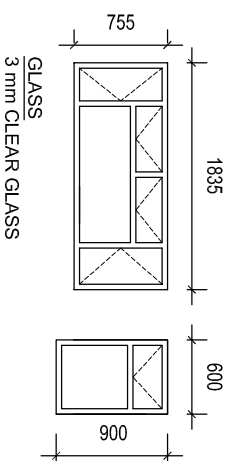

**ELECTRICAL LEGEND**

LIGHTS	SWITCHES
X	○
X	○
2 x 60 W	○
SOCKET OUTLET	○

**QUESTION 4: CIVIL DRAWING**

**Given:**

- An incomplete floor plan of the existing walls of a store room and the centre lines of the new walls of a proposed addition of a new laundry and toilet.
- The incomplete south elevation of the changes showing the new position of the windows, door, waste water disposal pipes, gully and FFL.
- The door and window schedule.
- The incomplete roof detail.
- The incomplete foundation and wall detail.
- An electrical legend.
- A starting point for drawing the floor plan on answer sheet 4.

**Instructions:**

Use answer sheet 4 and the information given on page 5 to draw the following views to a scale of 1:50 according to the given specifications:

- The complete floor plan showing all the changes.
- The complete south elevation showing all the changes.
- The complete sectional elevation A-A through the completed extension.

**SPECIFICATIONS:**

**THE FLOOR PLAN**

**With reference to the numbers on the floor plan the alterations are:**

- Remove existing window (1) and brick up.
- Demolish wall (2), remove door and make good.
- Extend wall (3) to the new position shown.

**The additions are:**

- Build in new 110 mm toilet walls (4).
- Build in the three new doors (5).
- Build in the two new windows (6).
- Add one fluorescent light (7) in the laundry and one ceiling light (7) in the toilet.
- Add one switched socket (8) in the laundry.
- Add one two pole switch (9) for the laundry and toilet.
- Insert a water closet (W/C), a basin (B) and a wash tub (C) as conventions.
- Insert the waste water disposal pipes and gully.
- Show the wall hatching.

**THE SOUTH ELEVATION**

**Complete the south elevation showing the following:**

- The floor, walls and roof.
- The door and window detail.
- The disposal pipes and gully detail.
- The finished floor level.

**THE SECTIONAL ELEVATION**

**Add the following features to the sectional elevation:**

- The complete foundation, walls, floor slab, screed and roof detail.
- The complete detail of the door and window.
- ALL necessary hatching.
- Label the sectional elevation: SECTIONAL ELEVATION A-A

[95]

**NOTE:**  
 ALL substructure hatching may be done in freehand.  
 ALL drawings must comply with the guidelines contained in the SABS 0143.

NAME
NAME