

**Teacher instruction:**

Ask learners to complete the other side of the house.  
They can use a little mirror to help them.  
They can then add the flowers, sun and trees to the pictures.  
*This is a visual memory and closure exercise.*

### Build the house

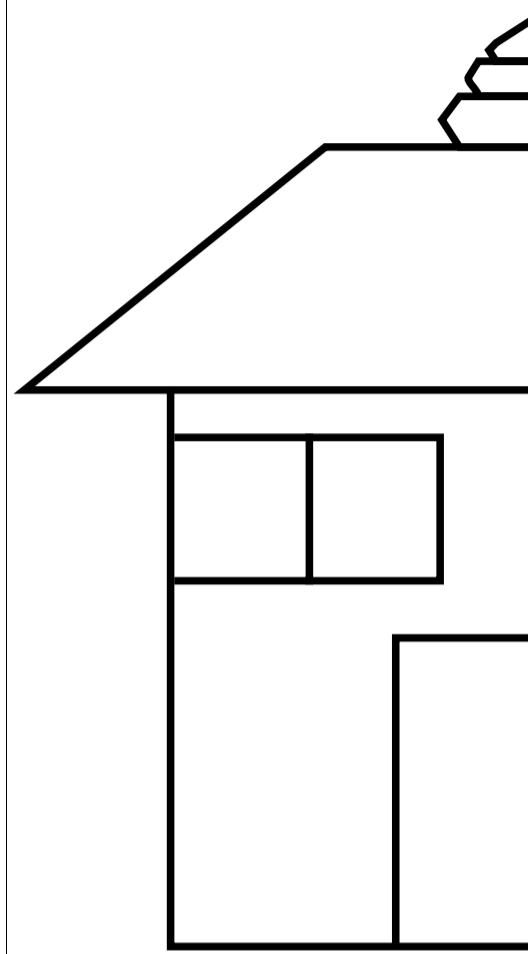
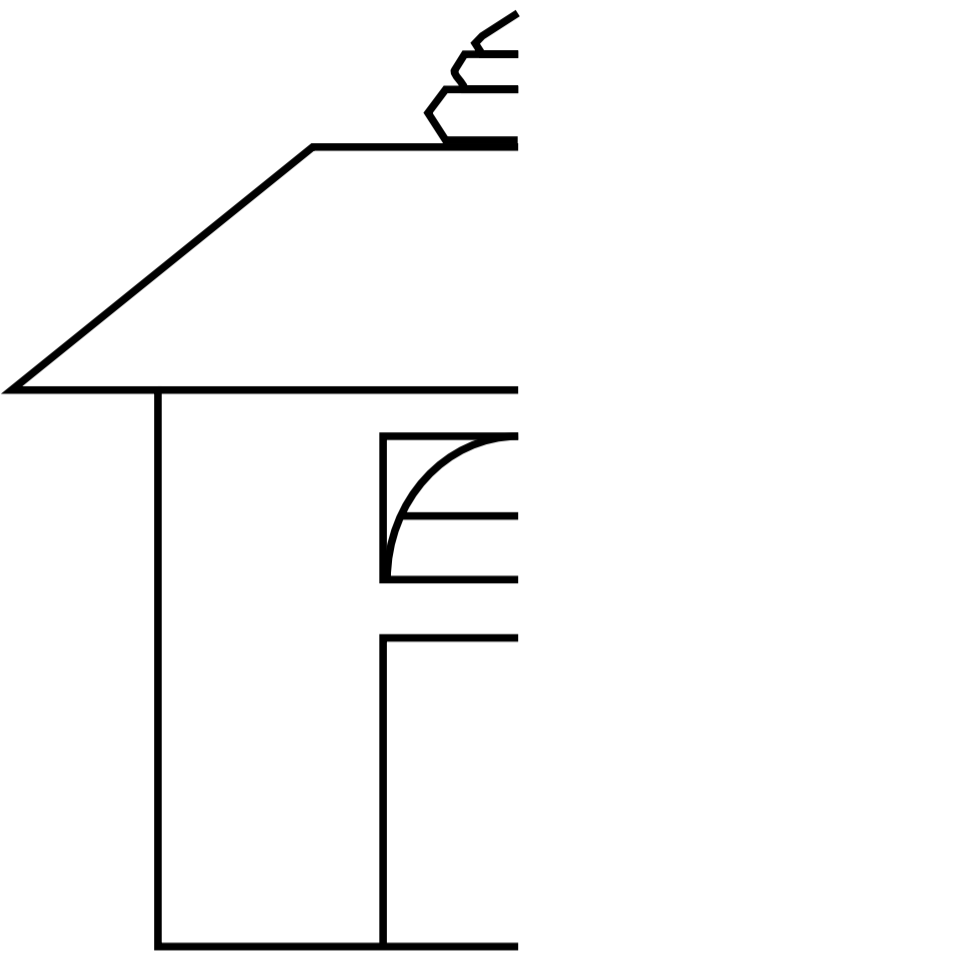

**Teacher instruction:**

Ask learners to match the different household items to the correct room, using a crayon.  
*This is a visual discrimination and fine motor exercise.*

### Where does this belong

